

CONTRA COSTA COMMUNITY COLLEGE

Los Medanos College

L-612 Business & Central Services Remodel

ADDENDUM #3 Date: June 29, 2011

NOTICE ALL CONTRACTORS SUBMITTING BIDS FOR THIS WORK AND TO ALL PLANHOLDERS:

You are hereby notified of the following changes, clarifications and/or modifications to the original Contract Documents, Project Manual, Drawings, Specifications and/or previous Addenda. This Addendum shall supersede the original Contract Documents and previous Addenda wherein it contradicts the same, and shall take precedence over anything to the contrary therein. All other conditions remain unchanged.

This Addendum forms a part of the Contract Documents and modifies the original Contract Documents dated **June 1, 2011**. Acknowledge receipt of this Addendum in space provided on the Bid Proposal Form. Failure to acknowledge may subject Bidder to disqualification.

A. DRAWINGS

ARCHITECTURAL DRAWINGS

1. Refer to Drawing A-1.2, SKA-01:
 - a. Add window type AL8 and AL9, per SKA-01.
2. Refer to Drawing A-1.3:
 - a. Furniture systems is N.I.C.. Provide infrastructure as called for in the documents.
3. Refer to Drawing A-1.4:
 - a. Furniture systems is N.I.C. Provide infrastructure as called for in the documents.
4. Refer to Drawing A-4.1, SKA-02:
 - a. Revised Partial Building Elevation 1, per SKA-02.
5. Refer to Drawing A-9.2, SKA-03 and SKA-04:
 - a. Revise Payroll (Office Area) 302a interior elevation 3, per SKA-03.
 - b. Revise Corridor 303 interior elevation 1, per SKA-04 (partial interior elevation shown only).

6. Refer to Drawing 2.01, SKA-05:
 - a. Revise Stair Section detail, per SKA-05.

7. Refer to Drawing 4.04, SKA-06, SKA-07, and SKA-08:
 - a. Add Pipe Penetration detail 16, per SKA-05.
 - b. Revise Metal Infill @ (E) Transom Storefront detail 13, per SKA-06.
 - c. Revise Back Upper Mtl Shelf Post detail 5, per SKA-07.

8. Refer to Drawing 6.04, SKA-09:
 - a. Add Countertop at Sliding Service Window detail 18, per SKA-08.

9. Refer to Drawing 8.02, SKA-10 and SKA-11:
 - a. Add Window type AL8 and AL9, per SKA-09.
 - b. Revise Window type HM2, per SKA-10.

ELECTRICAL DRAWINGS

1. Refer to Drawing E0.2:
 - a. One-Line Diagram: Change Transformer AXF@A208V/277/480@ to A480V/208/120V, 3 phase, 4W@

2. Refer to Drawing E3.1B, SKE-01:
 - a. Added disconnect in Electrical Room and wire gauge in IDF room, SKA-01.

3. Refer to Drawing E3.1C, SKE-02, SKE-03, and SKE-04:
 - a. Revise Demolition Sheet Note5, add Demolition Sheet Notes 9 and 10, and add New Sheet Notes 8 and 9 per SKE-02.
 - b. Revise Demolition Floor Plan, per SKE-03.
 - c. Revise Floor Plan, per SKE-04.

TELECOMMUNICATION DRAWINGS

1. Refer to Drawing TC-1, SKT-01, SKT-02, SKT-03, and SKT-04:
 - a. Revise General notes and Abbreviations, per SKT-01.
 - b. Revise Sheet Notes and Demolition notes, per SKT-02.
 - c. Revise Symbols, per SKT-03.
 - d. Revise Business Services Communications plan, per SKT-04.

2. Refer to Drawing TC-2, TC-2R:
 - a. Replace sheet TC-2 with TC-2R.

ADDENDUM #3

DSA App. # 01-111835
File #7-C1

B. Attachments

SKA-01, SKA-02, SKA-03, SKA-04, SKA-05, SKA-06, SKA-06, SKA-07, SKA-08, SKA-09, SKA-10,
SKA-11

SKE-01, SKE-02, SKE-03, SKE-04

SKT-01, SKT-02, SKT-03, SKT-04, TC-2R

If you have any questions regarding this Addendum No. 3, please contact the Office of the Facilities Planning & Management in writing, via facsimile or email to Jovan Esprit, Contract Manager jesprit@4cd.edu.

All other terms and conditions of BID are to remain the same.

tBP/Architecture

1000 Burnett Avenue, Suite 320
Concord CA 94520
925.246.6419

Architect of Record: Gary Frye

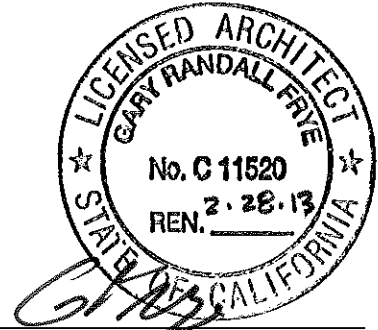

Architect of Record : Gary Frye

Division of State Architect

END OF ADDENDUM #3

ADDENDUM NO. 3
 DSA FILE # 7-C1
 DSA APPL.# 01-111835

BUILDING ENTRY

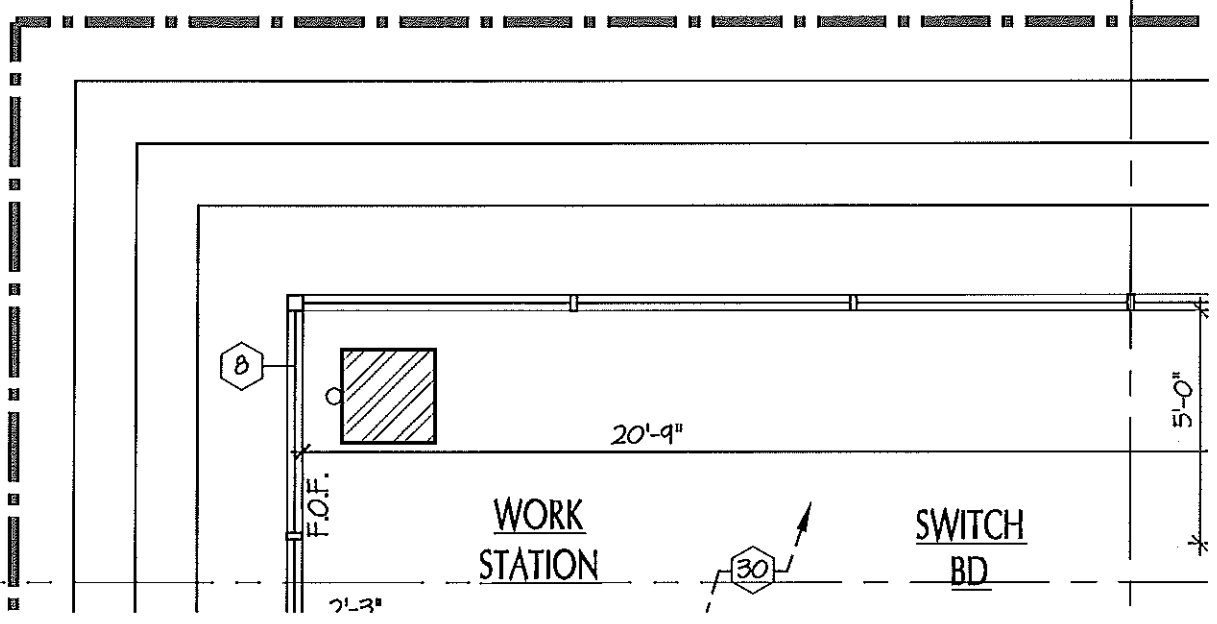
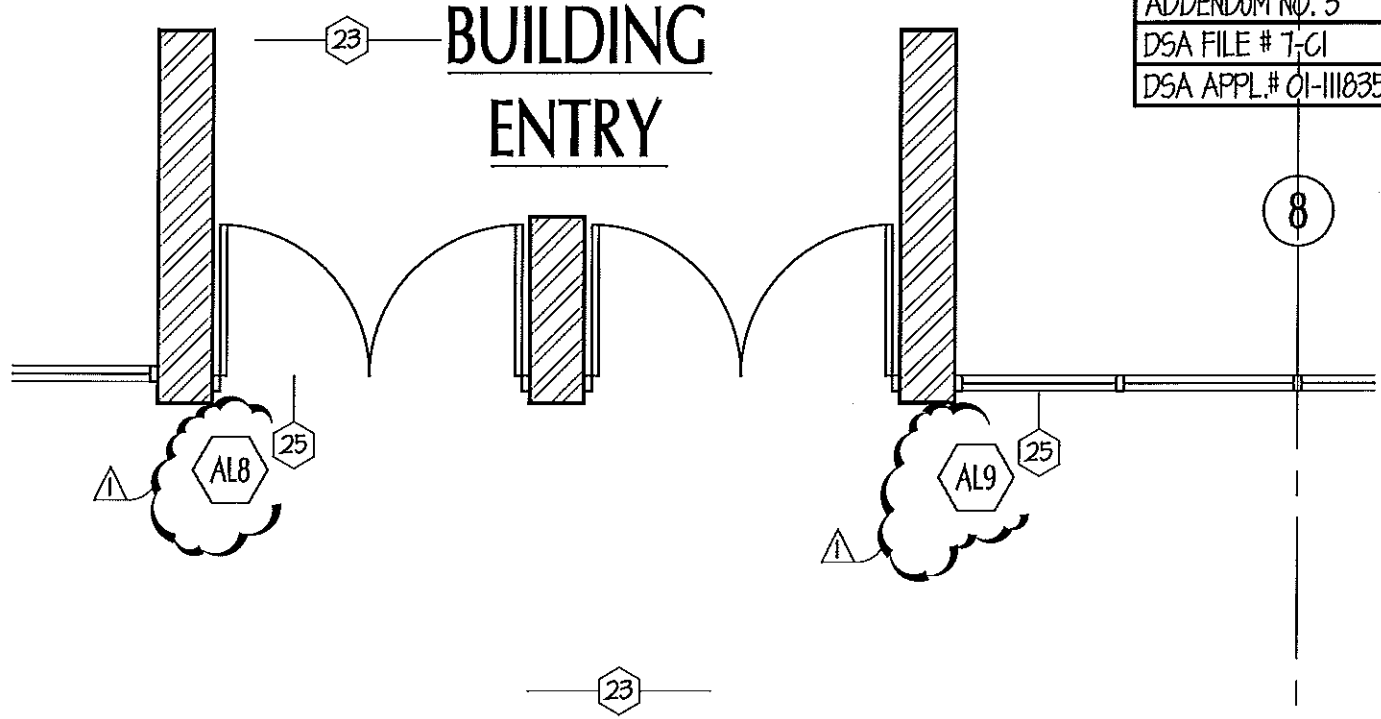

Business & Central Services Remodel
LOS MEDANOS COLLEGE
 Pittsburg, CA
 Contra Costa Community College
 School District

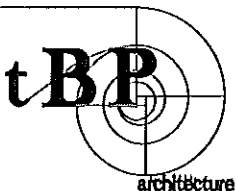

ARCHITECT
 tBP/Architecture
 1000 Burnett Ave, Suite 140
 Concord, CA 94520
 p 925.246.6419 f 925.246.6495

architecture
 planning
 interiors
 management

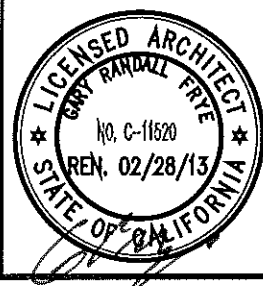

ADDENDUM NO. 3
 DATE: 06/29/11
 DSA NO. 01-111835
 THIS REVISES IN PART
 SHEET: A-1.2
 SHEET: SKA-01

ADDENDUM No. 3
 DSA FILE # 7-C1
 DSA APPL.# 01-111835

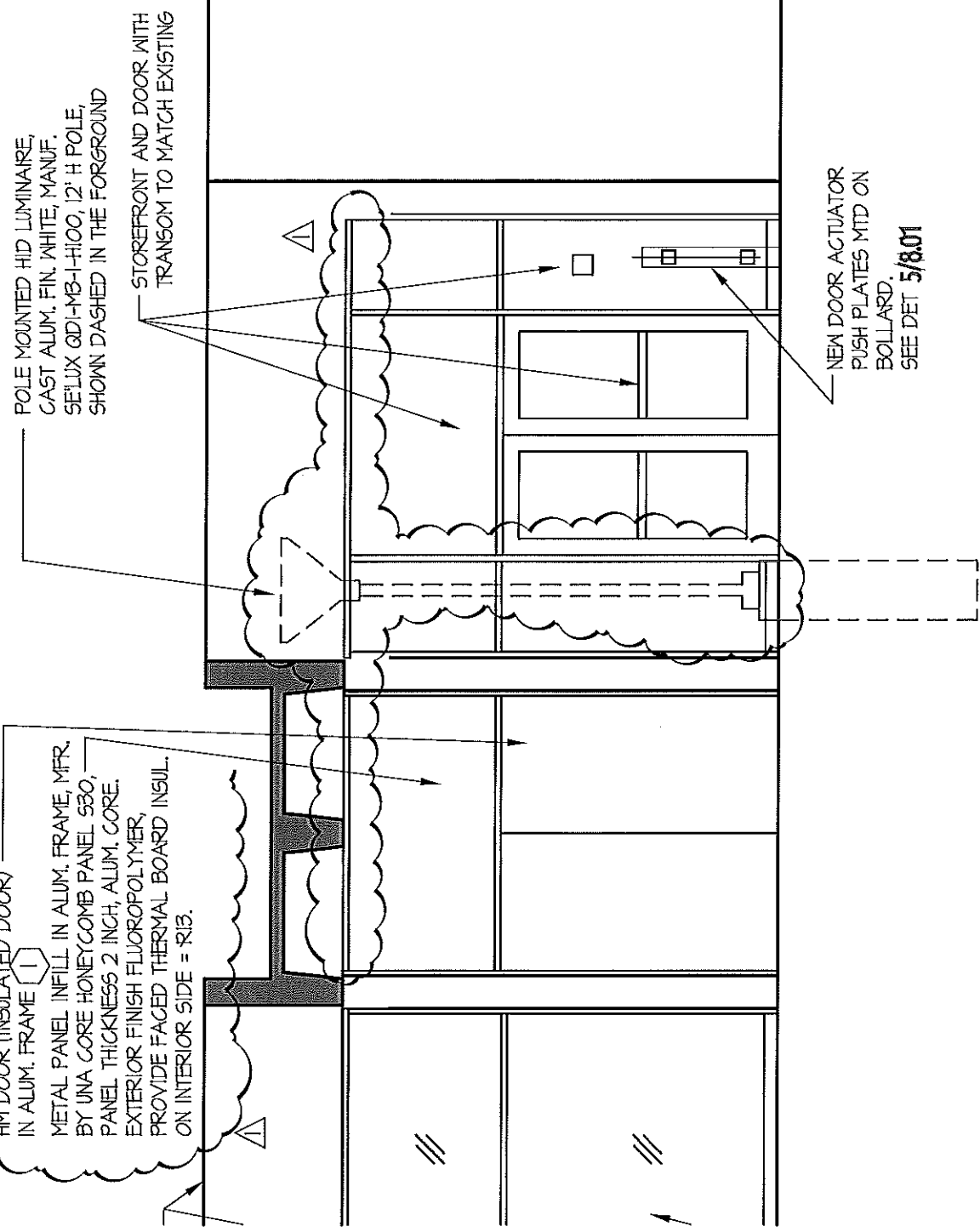

PARTIAL BUILDING ELEVATION - BUSINESS SERVICES
 N.T.S.

Business & Central Services Remodel
LOS MEDANOS COLLEGE

Pittsburg, CA
 Contra Costa Community College
 School District

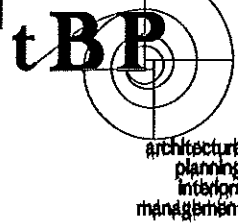

ARCHITECT
 tBP/Architecture
 1010 Burnett Ave, Suite 140
 Concord, CA 94520
 P: 925.246.6419 F: 925.246.6495

architecture
 planning
 interiors
 management

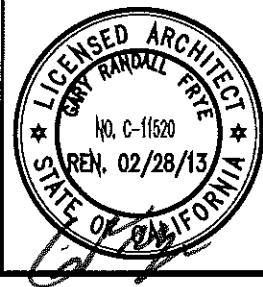

ADDENDUM No. 3
 DATE: 06/29/11
 DSA NO. 01-111835
 THIS REVISES IN PART SHEET: A-4.1
 SHEET: SKA-2

ADDENDUM NO. 3
 DSA FILE # 7-C1
 DSA APPL.# 01-111835

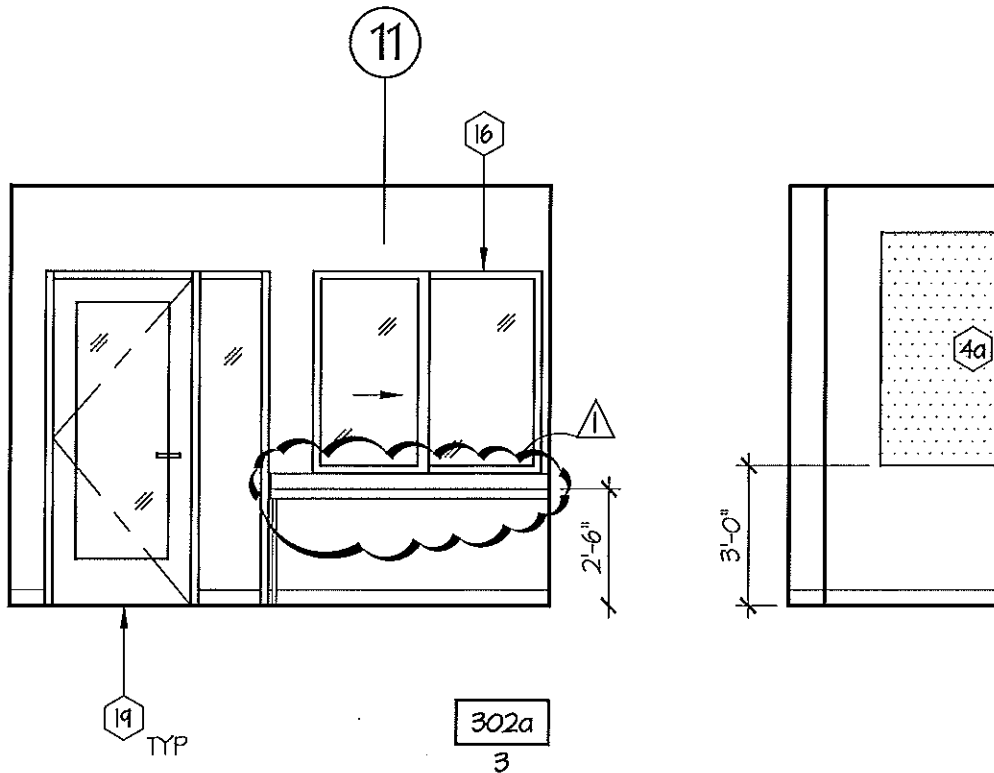

| | |
|--|-------------|
| PAYROLL (OFFICE AREA) <small>SCALE: 1/4" = 1'-0"</small> | 302a |
|--|-------------|

Business & Central Services Remodel
LOS MEDANOS COLLEGE

Pittsburg, CA
 Contra Costa Community College
 School District

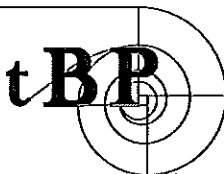

ARCHITECT

tBP/Architecture
 1000 Burnett Ave, Suite 140
 Concord, CA 94520
 ph 925.246.6419 f 925.246.6495

architecture
 planning
 interiors
 management

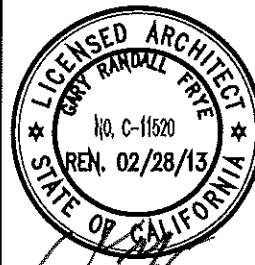

ADDENDUM NO. 3
 DATE: 06/29/11
 DSA NO. 01-111835
 THIS REVISES IN PART
 SHEET: A-9.2
 SHEET: SKA-03

ADDENDUM NO. 3
 DSA FILE # 7-C1
 DSA APPL.# 01-111835

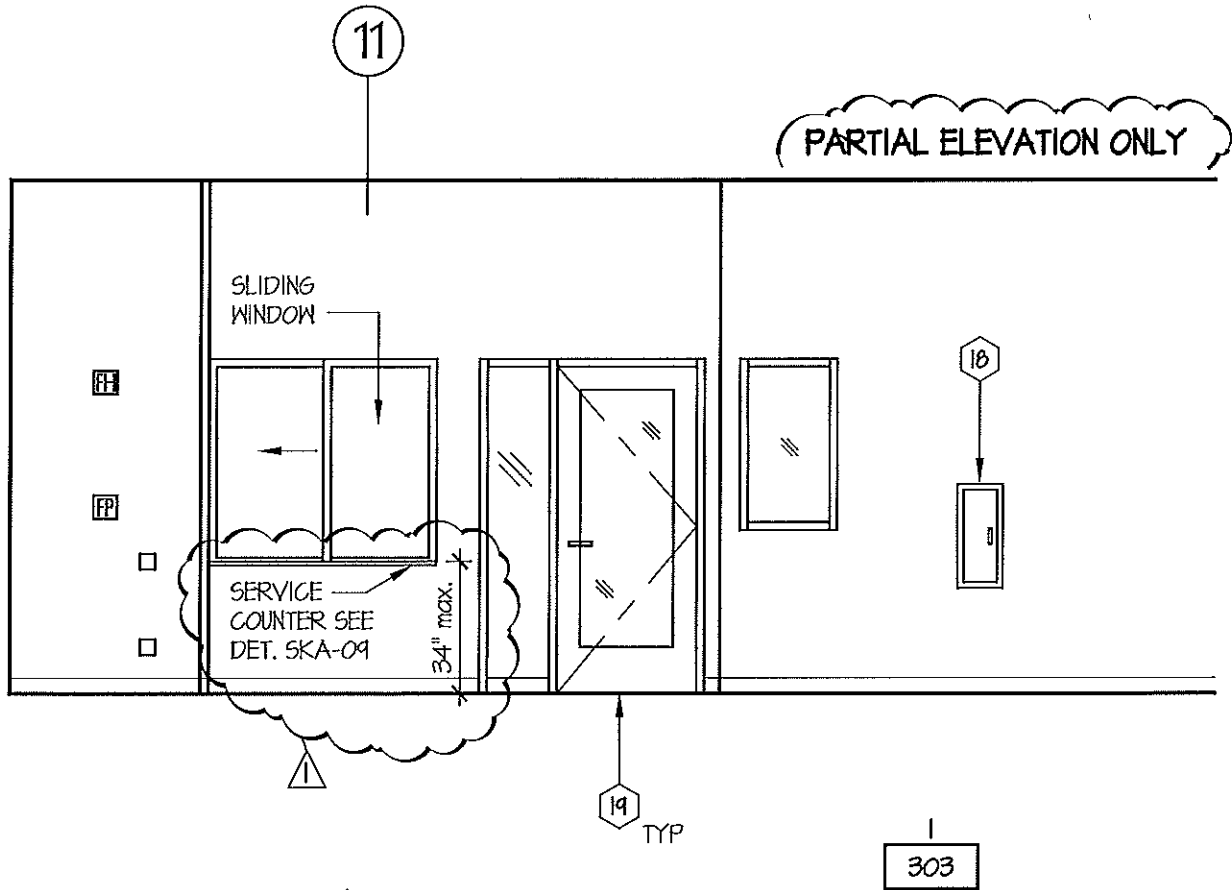

CORRIDOR
 SCALE: 1/4" = 1'-0"

303

**Business & Central Services Remodel
 LOS MEDANOS COLLEGE**

Pittsburg, CA
 Contra Costa Community College
 School District

ARCHITECT

tBP/Architecture
 1000 Burnett Ave, Suite 140
 Concord, CA 94520
 p: 925.246.6419 f: 925.246.6495

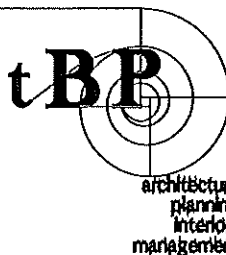

architecture
 planning
 interiors
 management

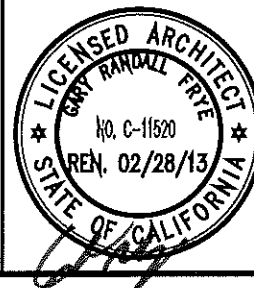

ADDENDUM NO. 3

DATE: 06/29/11

DSA NO. 01-111835

THIS REVISES IN PART
 SHEET: A-9.2

SHEET: SKA-04

ADDENDUM NO. 3
 DSA FILE # 7-C1
 DSA APPL.# 01-111835

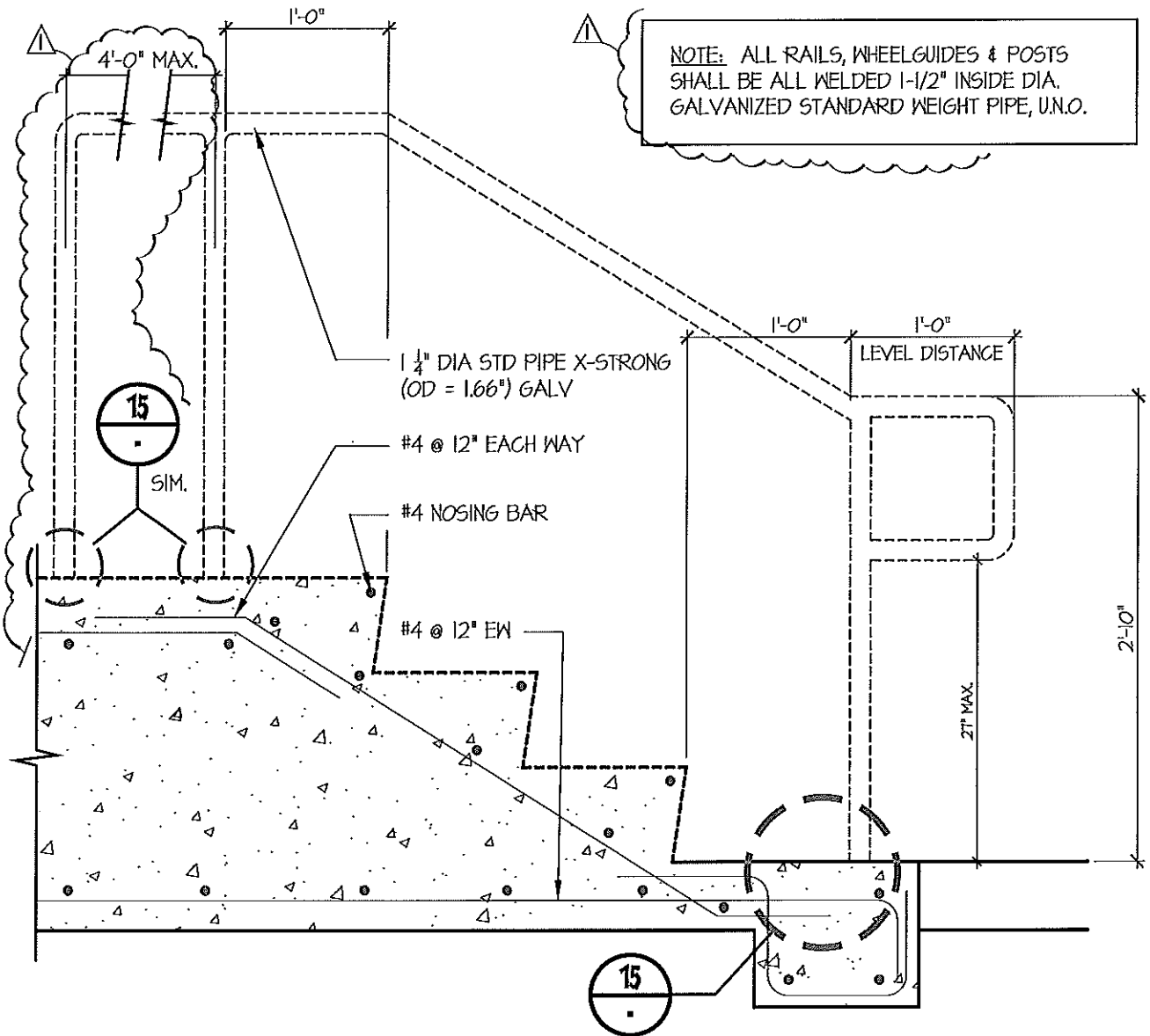

STAIR SECTION 20
 SCALE: 1" = 1'-0"

Business & Central Services Remodel
LOS MEDANOS COLLEGE
 Pittsburg, CA
 Contra Costa Community College
 School District



ARCHITECT
 tBP/Architecture
 1000 Burnett Ave, Suite 140
 Concord, CA 94520
 ph 925.246.6419 ff 925.246.6495

architecture
 planning
 interiors
 management

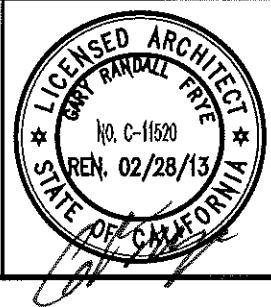

ADDENDUM NO. 3
 DATE: 06/29/11
 DSA NO. 01-111835
 THIS REVISES IN PART
 SHEET: 2.01
 SHEET: SKA-05

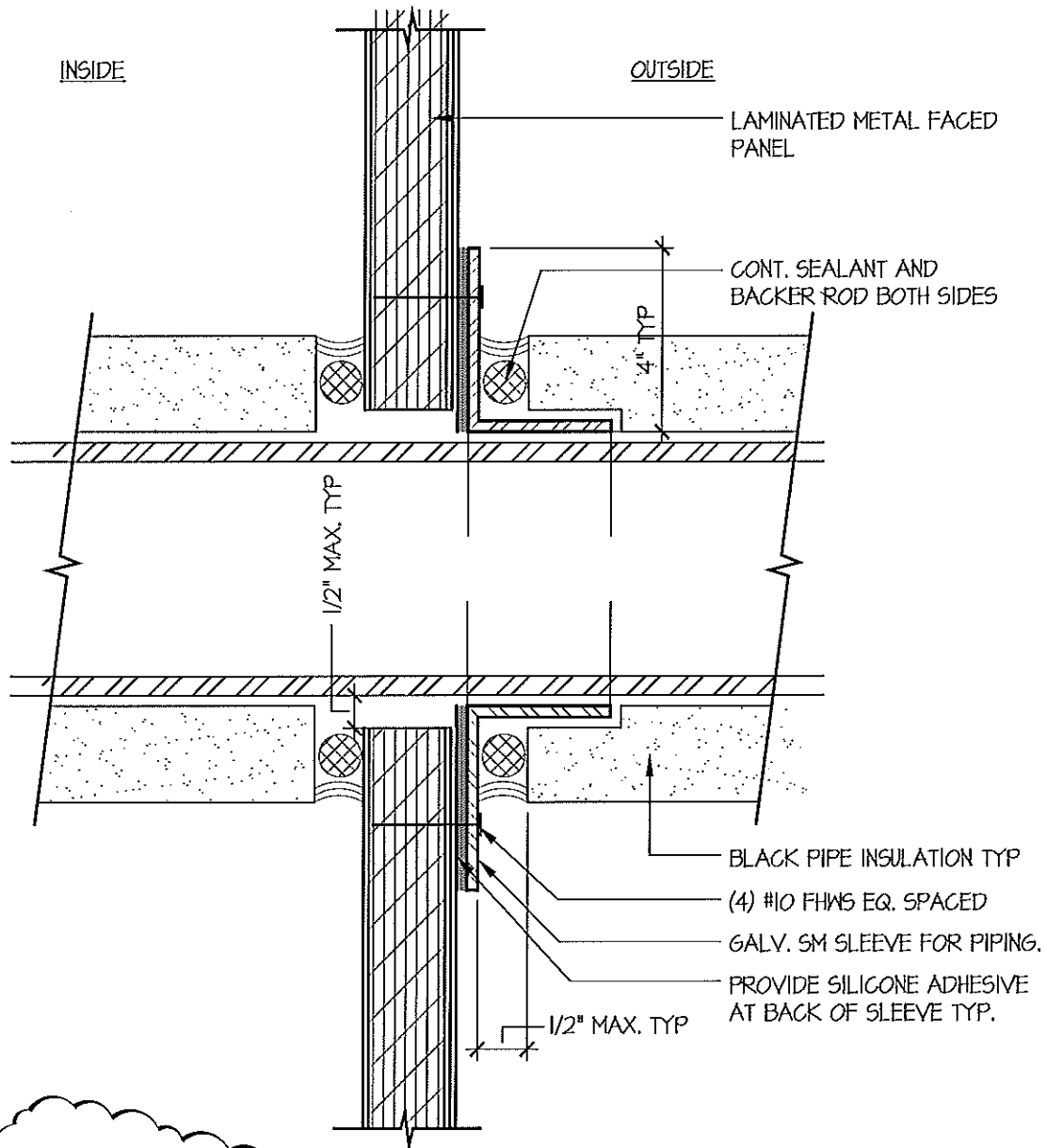

PIPE PENETRATION ▲

SCALE: N.T.S.

16

**Business & Central Services Remodel
 LOS MEDANOS COLLEGE**

Pittsburg, CA
 Contra Costa Community College
 School District

ARCHITECT

tBP/Architecture
 1000 Burnett Ave, Suite 140
 Concord, CA 94520
 ph 925.246.6419 fx 925.246.6495



architecture
 planning
 interiors
 management

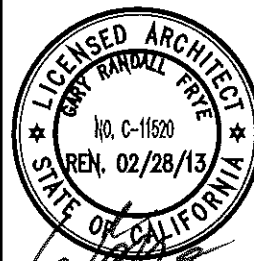

ADDENDUM NO. 3

DATE: 06/29/11

DSA NO. 01-111835

THIS REVISES IN PART
 SHEET: 4.04

SHEET: SKA-06

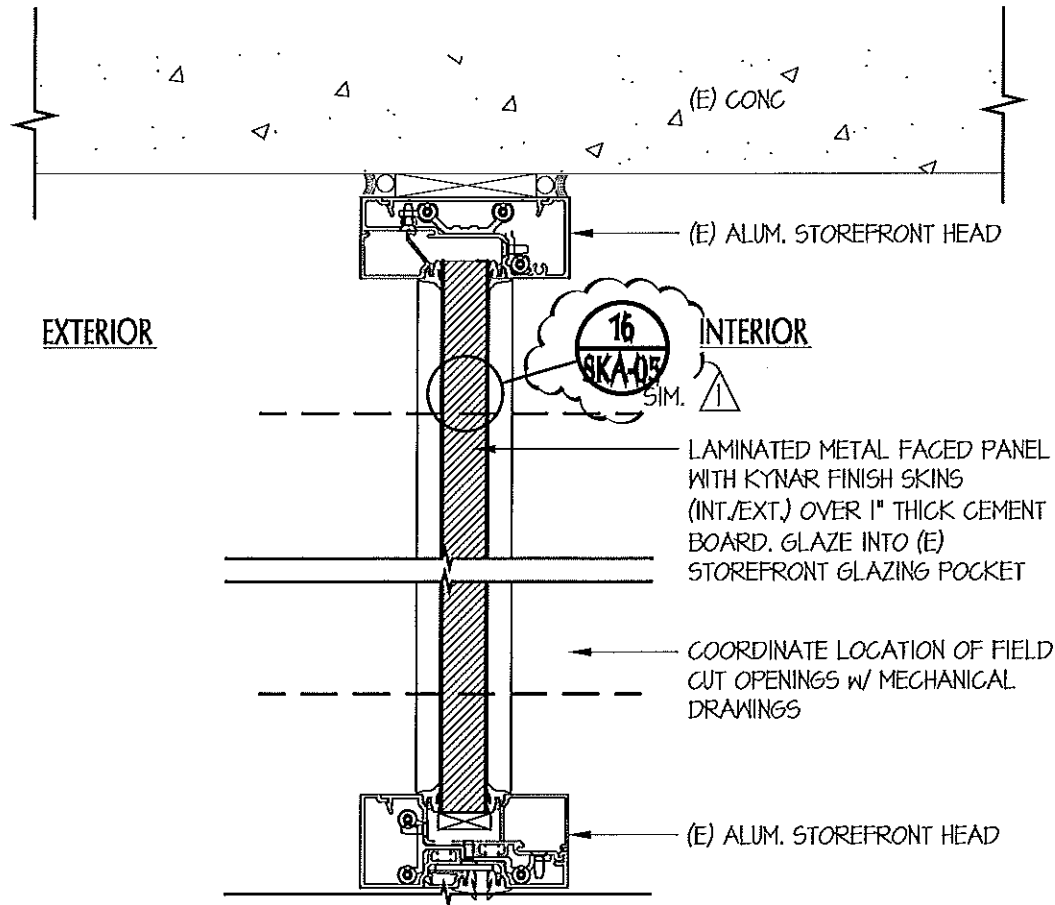

Manufacture by Mapes-R or approved equal Thickness 1", submit submittal for review.
 Ext. Fin.: Custom Kynar
 Ext. Substrate: Cement board
 Core: Isocyanurate
 Int. Substrate: Cement board
 Int. Fin Custom Kynar.

METAL INFILL PANEL @ (E) TRANSOM STOREFRONT 13
 SCALE: 3" = 1'-0"

Business & Central Services Remodel
LOS MEDANOS COLLEGE

Pittsburg, CA
 Contra Costa Community College
 School District

ARCHITECT

tBP/Architecture
 1000 Burnett Ave, Suite 140
 Concord, CA 94520
 ph 925.246.6419 f 925.246.6495



architecture
 planning
 interiors
 management

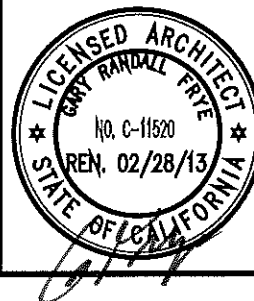

ADDENDUM NO. 3

DATE: 06/29/11

DSA NO. 01-111835

THIS REVISES IN PART
 SHEET: 4.04

SHEET: SKA-07

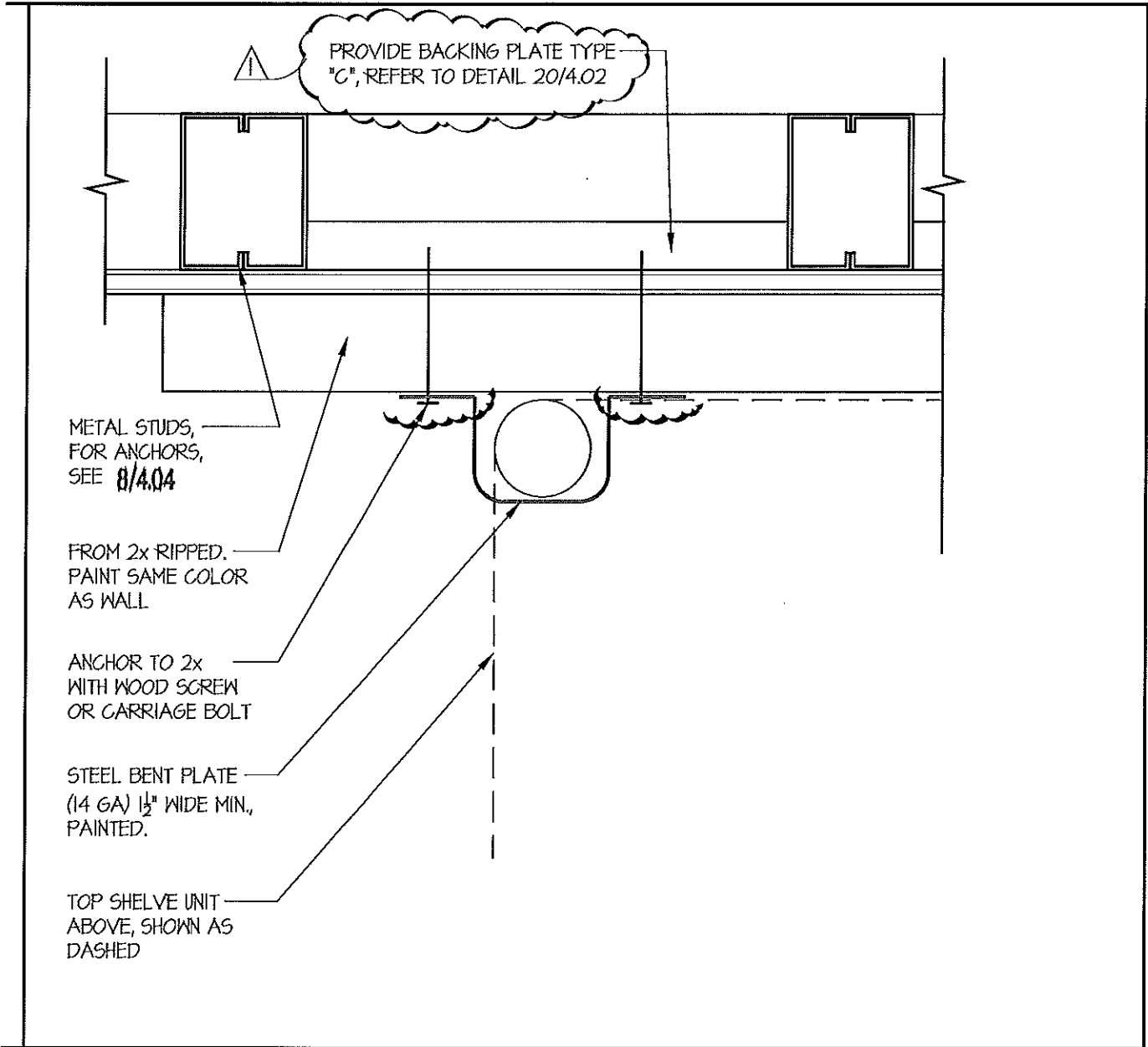

BACK UPPER MTL SHELF POST

5

SCALE: NTS

A

**Business & Central Services Remodel
 LOS MEDANOS COLLEGE**

Pittsburg, CA
 Contra Costa Community College
 School District

ARCHITECT

tBP/Architecture
 10000 Burnett Ave, Suite 140
 Concord, CA 94520
 p: 925.246.6419 f: 925.246.6495

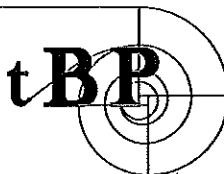

architecture
 planning
 interiors
 management

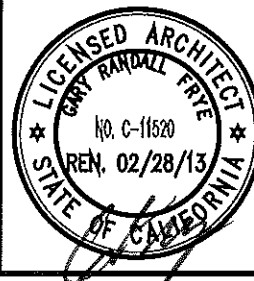

ADDENDUM NO. 3

DATE: 06/29/11

DSA NO. 01-III835

THIS REVISES IN PART
 SHEET: 4.04

SHEET: SKA-08

ADDENDUM NO. 3
 DSA FILE # 7-C1
 DSA APPL.# 01-111835

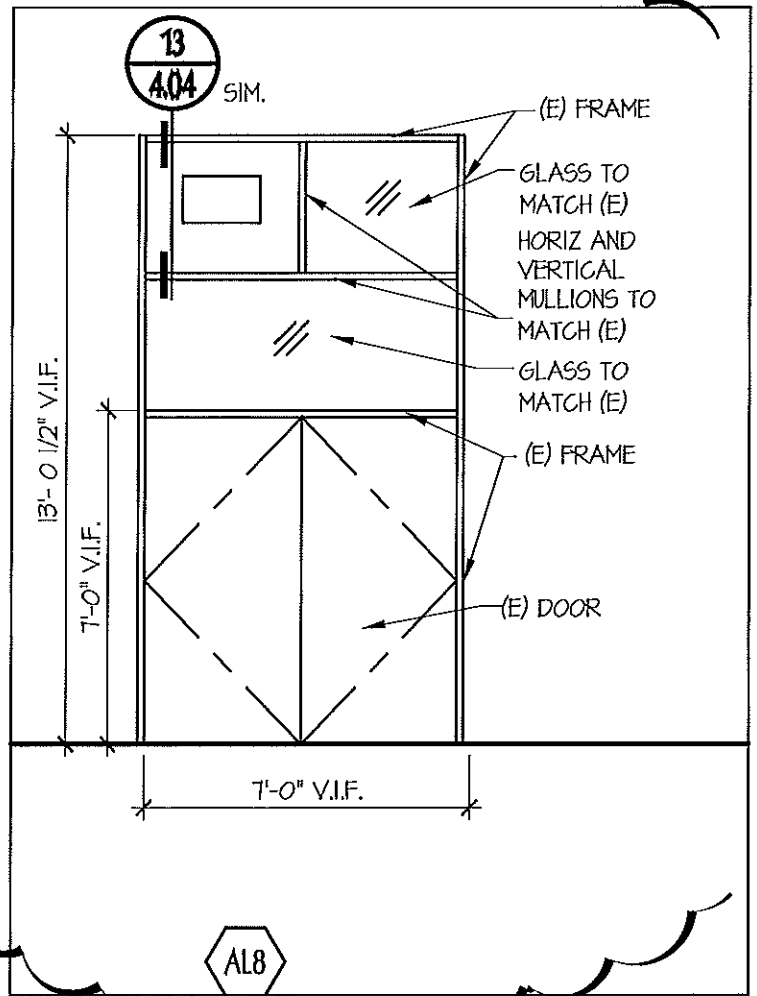
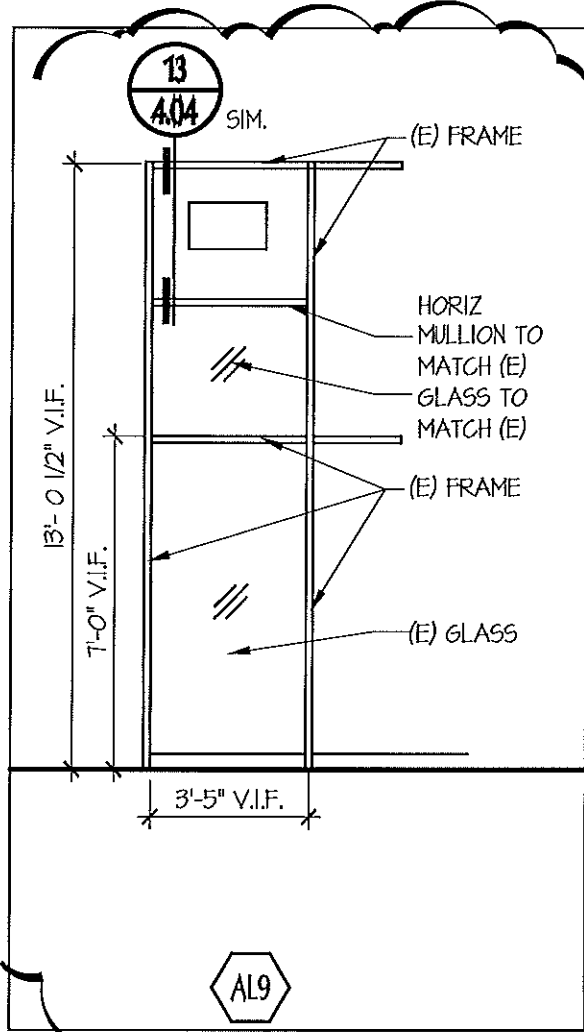

Business & Central Services Remodel
LOS MEDANOS COLLEGE

Pittsburg, CA
 Contra Costa Community College
 School District

ARCHITECT

tBP/Architecture
 10000 Burnett Ave, Suite 140
 Concord, CA 94520
 p: 925.246.6419 f: 925.246.6495

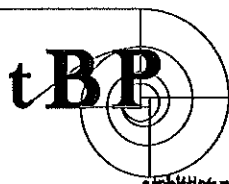

architecture
 planning
 interiors
 management

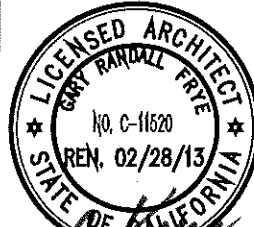

ADDENDUM NO. 3
 DATE: 06/29/11
 DSA NO. 01-111835
 THIS REVISES IN PART
 SHEET: 8.02
 SHEET: SKA-10

ADDENDUM NO. 3
 DSA FILE # 7-01
 DSA APPL.# 01-111835

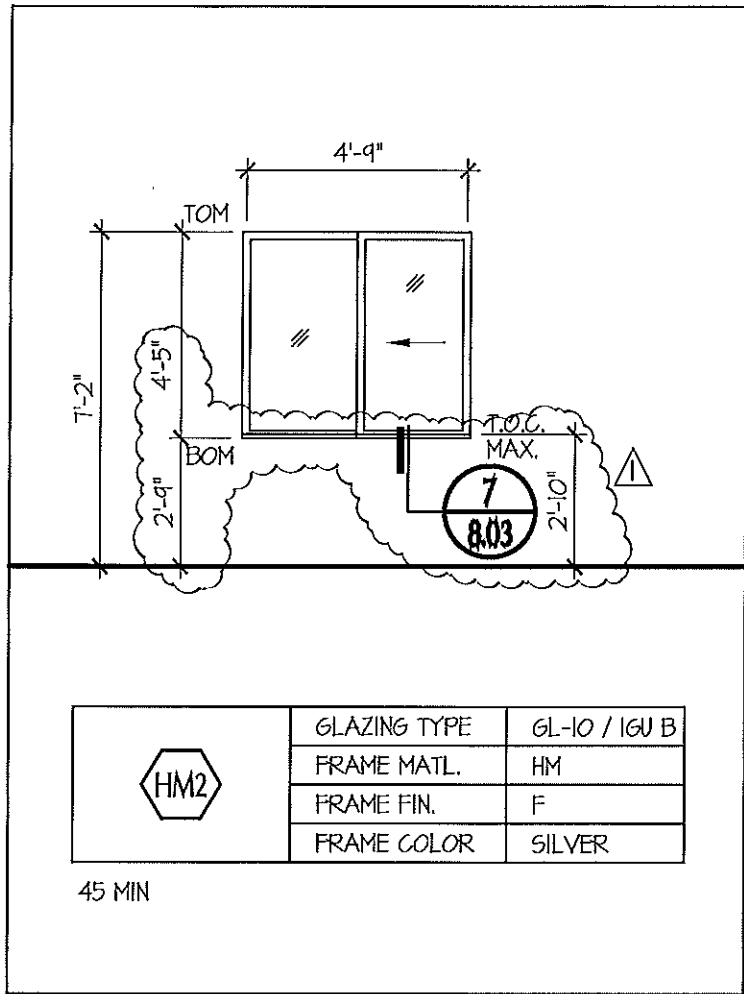

Business & Central Services Remodel
LOS MEDANOS COLLEGE

Pittsburg, CA
 Contra Costa Community College
 School District

ARCHITECT

tBP/Architecture
 1000 Burnett Ave, Suite 140
 Concord, CA 94520
 pt 925.246.6419 fx 925.246.6495

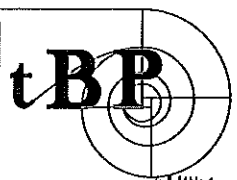

architecture
 planning
 interiors
 management

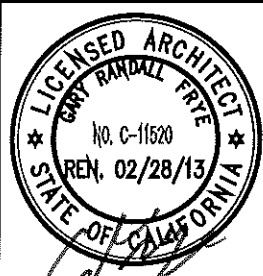

ADDENDUM NO. 3
 DATE: 06/29/11
 DSA NO. 01-111835
 THIS REVISES IN PART
 SHEET: 8.02
 SHEET: SKA-II

DEMOLITION SHEET NOTES

① ⑤ EXISTING FLOOR JUNCTION BOX FROM EXISTING 277 VOLT LIGHTING CIRCUIT TO REMAIN. EXISTING CONDUIT AND WIRING CONNECTION IS UNKNOWN. VERIFY IN FIELD AND NOTE ON AS-BUILTS FOR FUTURE. SEE DEMOLITION SHEET NOTE 9.

① ⑨ EXISTING CONDUIT ROUTING IS UNKNOWN AND POSSIBLE OPTIONS ARE SHOWN. ELECTRICAL CONTRACTOR IS TO VERIFY ROUTING IN THE FIELD. IT IS ASSUMED THAT CONDUIT AND WIRING PATHWAY(S) INTERFERE WITH PLUMBING LINE THAT IS BEING INSTALLED. ELECTRICAL CONTRACTOR SHALL INTERCEPT EXISTING CONDUIT(S) AND RECONNECT AS REQUIRED BY NEW PLUMBING LINE. ALL WIRING SHALL BE REPULLED IN A CONTINUOUS CONDUIT RUN BETWEEN BOXES AND RECORDED ON AS-BUILTS.

① ⑩ EXISTING FLOOR JUNCTION BOX IS TO BE RELOCATED TO CLEAR NEW CABINETS. COORDINATE EXACT LOCATION IN THE FIELD WITH ARCHITECT AND COORDINATE WITH DEMOLITION NOTES 5 AND 9, THIS SHEET.

NEW SHEET NOTES

① ⑧ EXISTING LIGHTING FLOOR JUNCTION BOX. EXISTING AND/OR REROUTED CONDUIT RUNS ARE NOT SHOWN ON THIS PLAN. ELECTRICAL SHALL RECORD EXISTING AND/OR NEW ROUTING PER DEMOLITION NOTES 5, 9 AND 10.

① ⑨ RELOCATED LIGHTING FLOOR JUNCTION BOX. EXISTING AND/OR REROUTED CONDUIT RUNS ARE NOT SHOWN ON THIS PLAN. ELECTRICAL CONTRACTOR SHALL RECORD EXISTING AND/OR NEW ROUTING PER DEMOLITION NOTES 5, 9 AND 10.

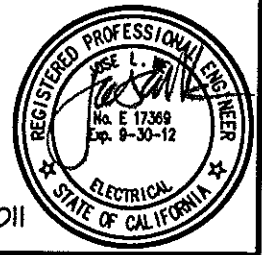

WHM INC. 1605 SCHOOL ST., MORAGA, CA. 94556 (925) 376-2902 cad@whminc.com WHM JOB #10-011

06/28/11 3:26:34 PM F:\2010\10-011 LMC\10011E3.1C.DWG

Business & Central Services Remodel
LOS MEDANOS COLLEGE

Pittsburg, CA
 Contra Costa Community College
 School District

ARCHITECT
 tBP/Architecture
 1000 Burnett Ave, Suite 140
 Concord, CA 94520
 p: 925.246.6419 f: 925.246.6495

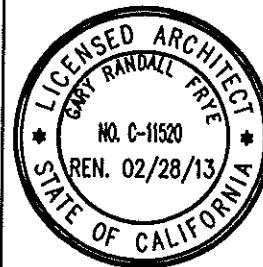
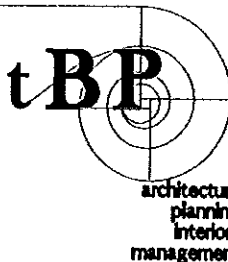

ADDENDUM
 DATE:
 DSA NO. 01-111835
 THIS REVISES IN PART
 SHEET: E3.1C
 SHEET: **SKE-02**

ADDENDUM No.
 DSA FILE # 7-C1
 DSA APPL.# 01-111835

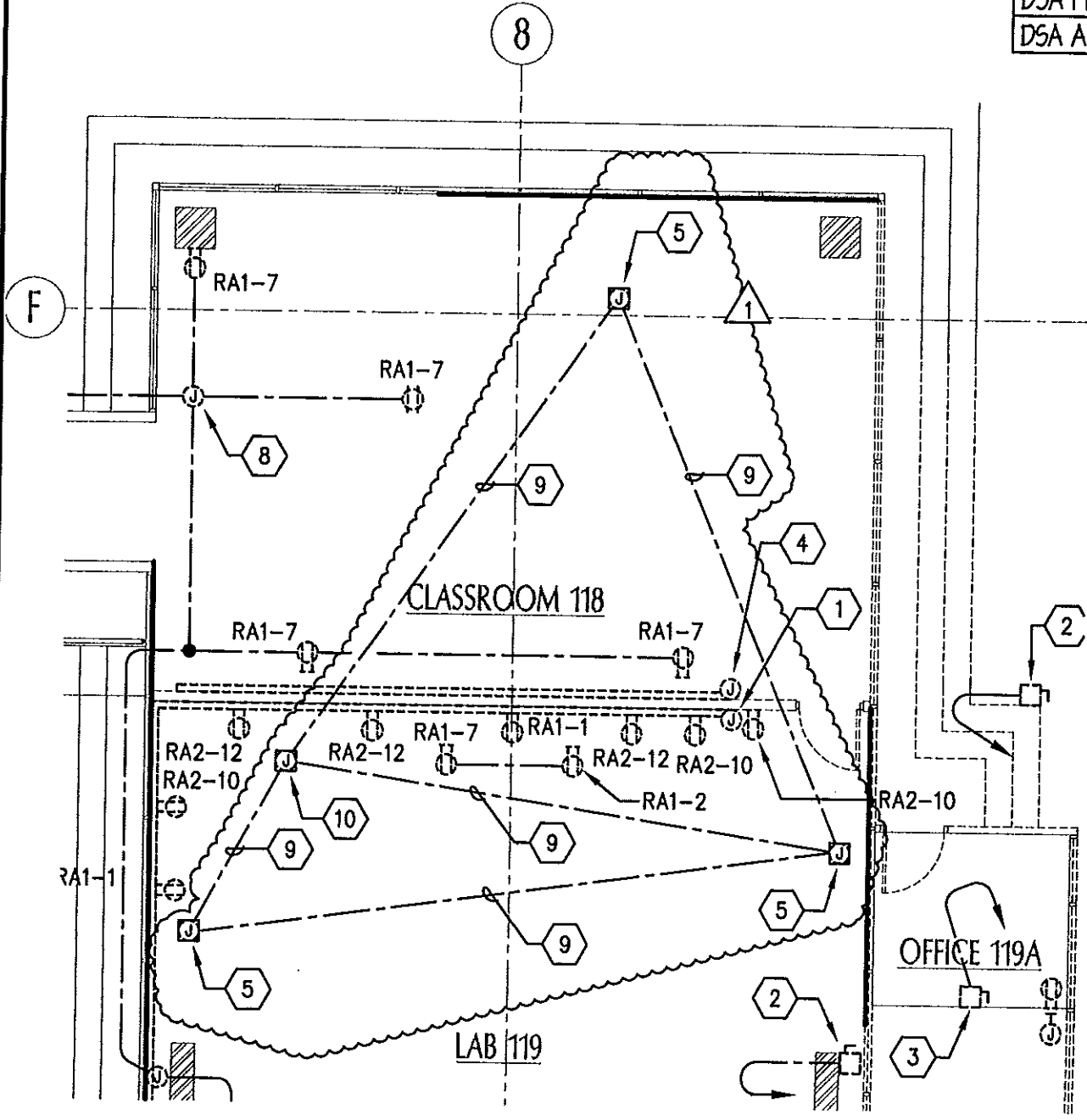

1 ELECTRICAL DEMOLITION POWER PLAN

SCALE: 1/8" = 1'-0"

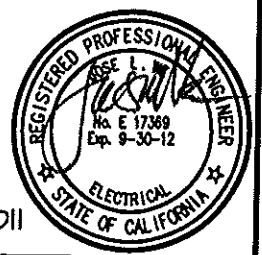
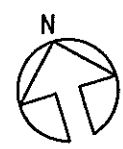

WHM INC. 1605 SCHOOL ST., MORAGA, CA. 94556 (925) 376-2902 cad@whminc.com WHM JOB #10-011

Business & Central Services Remodel
LOS MEDANOS COLLEGE

Pittsburg, CA
 Contra Costa Community College
 School District



ARCHITECT
 tBP/Architecture
 1000 Burnett Ave, Suite 140
 Concord, CA 94520
 p: 925.246.6419 f: 925.246.6495

architecture
 planning
 interiors
 management

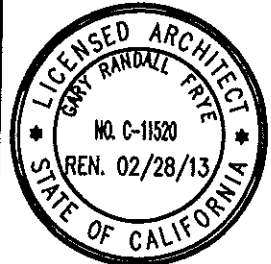

ADDENDUM
 DATE:
 DSA NO. 01-111835
 THIS REVISES IN PART
 SHEET: E3.1C
 SHEET: **SKE-03**

06/28/11 3:26:43 PM F:\2010\10-011 LMC\10011E3.1C.DWG

ADDENDUM No.
 DSA FILE # 7-C1
 DSA APPL.# 01-111835

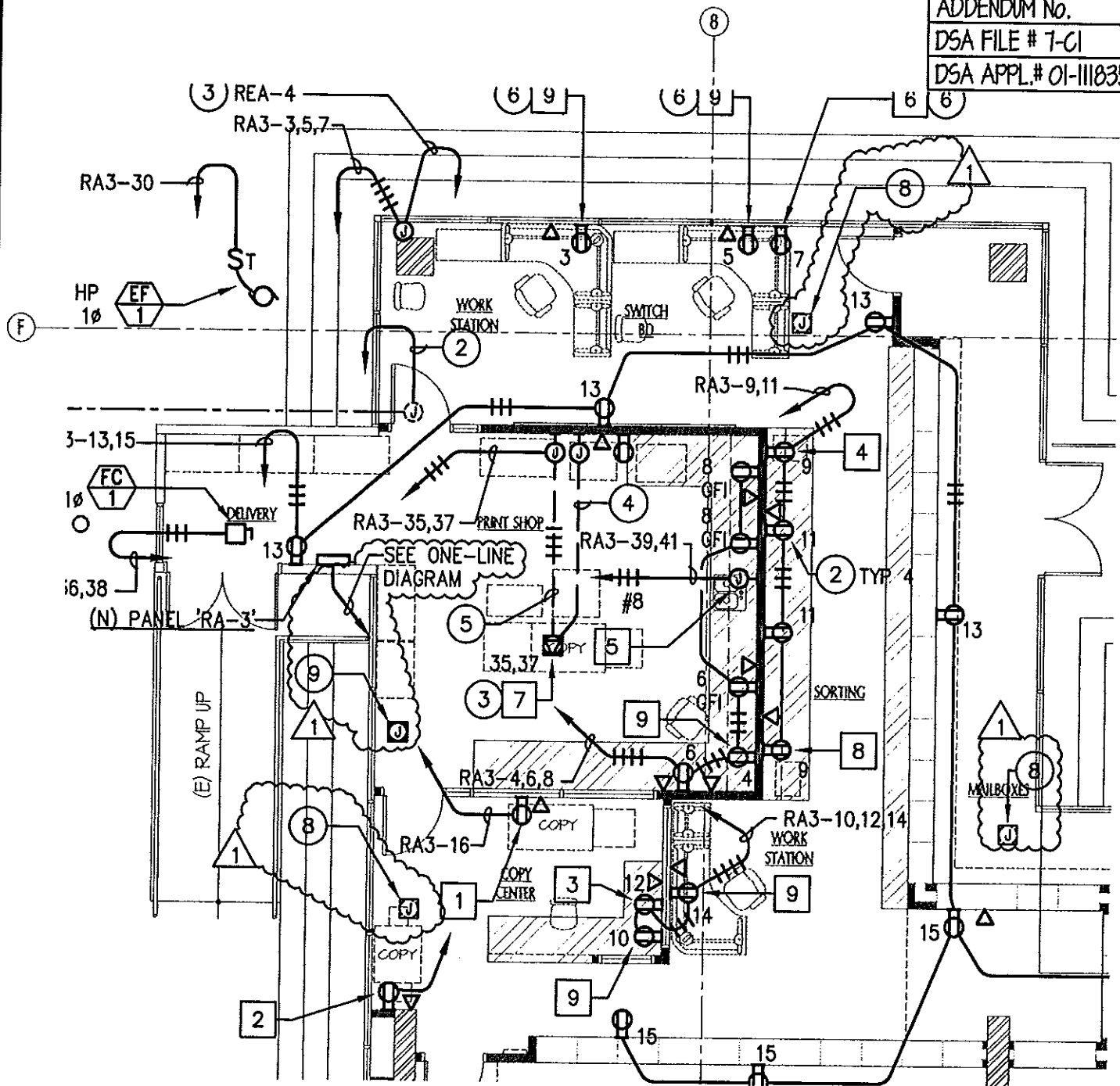

2 ELECTRICAL POWER PLAN
 SCALE: 1/8" = 1'-0"



WHM INC. 1605 SCHOOL ST., MORAGA, CA. 94556 (925) 376-2902 cad@whmInc.com WHM JOB #10-011

Business & Central Services Remodel
LOS MEDANOS COLLEGE

Pittsburg, CA
 Contra Costa Community College
 School District



ARCHITECT

tBP/Architecture
 1000 Burnett Ave, Suite 140
 Concord, CA 94520
 p: 925.246.6419 f: 925.246.6495

architecture
 planning
 interiors
 management

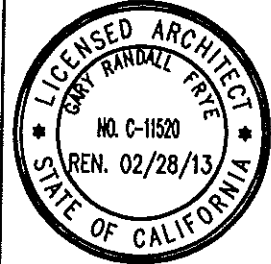

ADDENDUM
 DATE:
 DSA NO. 01-111835
 THIS REVISES IN PART
 SHEET: E3.1C
 SHEET: **SKE-04**

06/28/11 3:26:51 PM F:\2010\10-011 LMC\10011E3.1C.DWG

GENERAL:

16. EXTEND 1" C (U.O.N.) FROM WAO TO CABLE TRAY OR IDF CLOSET
17. INSTALL CABLE TRAY WITH CONTOURED BENDS – NO 90° CORNERS.
INSTALL CABLE TRAY ABOVE HVAC DUCTING.
18. MAINTAIN 3" CLEAR ABOVE CABLE TRAY (EXCEPT WITH PASSING OVER
HVAC DUCTING) WHEN INSTALLING CABLE TRAY
19. DRAWING IS SCHEMATIC, REFER TO ARCHITECTURAL DRAWINGS FOR
DIMENSIONED LOCATIONS OF WAOS



ABBREVIATIONS:

AC – ABOVE COUNTER

AFF – ABOVE FINISHED FLOOR

AV (OR AV) – AUDIO VISUAL

C.T. – CABLE TRAY



SMR – SURFACE MOUNTED RACEWAY

TR – TELECOMMUNICATIONS ROOM. SAME AS IDF

U.O.N. – UNLESS OTHERWISE NOTED

WAO – WORK AREA OUTLET

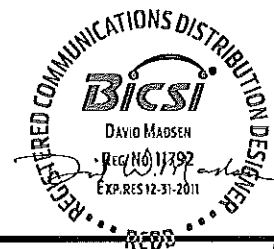

**MADSEN &
ASSOCIATES**

21 PALO ALTO COURT
PLEASANT HILL, CA 94523

P: 925.216.1576 F: 925.271.8805
EMAIL: @DAVEMADSEN.COM

**Business & Central Services Remodel
LOS MEDANOS COLLEGE**

Pittsburg, CA
Contra Costa Community College
School District

ARCHITECT

tBP/Architecture
1000 Burnett Ave, Suite 140
Concord, CA 94520
p: 925.246.6419 f: 925.246.6495



architecture
planning
interiors
management

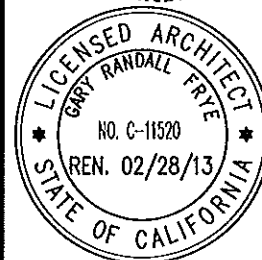

ADDENDUM

DATE:

DSA NO. 01-111835

THIS REVISES IN PART

SHEET: **TC-1**

SHEET: **SKT-01**

SHEET NOTES:

ADDENDUM No.
DSA FILE # 7-C1
DSA APPL.# 01-111835

1. REMOVE TTB PLYWOOD BACKBOARD
2. REMOVE SURFACE MOUNTED RACEWAY
3. REMOVE POWER/DATA POLE

4. CABLE TRAY SIZE: 1-1/2" X 6" (MINIMUM)

5. 4" SLEEVE



DEMOLITION:

1. REMOVE SURFACE MOUNTED RACEWAY AND POWER POLES WHERE NOT SPECIFICALLY NOTED TO BE RE-USED

2. REMOVE TTB PLYWOOD BACKBOARD (SHEET NOTE #1)

3. REMOVE OVERHEAD PROJECTOR MOUNTING HARDWARE AND TURN OVER TO DISTRICT



4. AT LOCATIONS WHERE COMMUNICATION DEVICE BOXES ARE CAST IN CONCRETE AND ARE NOT RE-USED, REMOVE CABLING, LEAVE JET-LINE THROUGH CONDUIT NOTING THE ROOM NUMBER ON THE CONDUIT IN THE (E)IDF. PROVIDE STAINLESS STEEL COVER PLACE AT DEVICE BOX.

5. REFER TO SHEET NOTES FOR ADDITIONAL DEMOLITION REQUIREMENTS

6. REMOVE TERMINATION HARDWARE IN (E)IDF RM 2502 AND DATA 125 THAT IS ABANDONED OR BECOMES ABANDONED AS PART OF THIS WORK.



MADSEN & ASSOCIATES
 21 PALO ALTO COURT
 PLEASANT HILL, CA 94623
 P: 925.216.1575 F: 925.271.8805
 EMAIL: DAVE@MADSEN.COM

Bicsi
 REGISTERED COMMUNICATIONS DISTRIBUTION DESIGNER
 No. C-11520
 EXP. 02/28/13
 RCD

Business & Central Services Remodel
LOS MEDANOS COLLEGE

Pittsburg, CA
Contra Costa Community College
School District

ARCHITECT

tBP/Architecture
1000 Burnett Ave, Suite 140
Concord, CA 94520
p: 925.246.6419 f: 925.246.6495

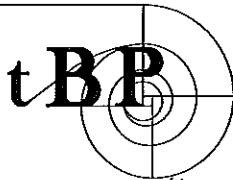

architecture
planning
interiors
management

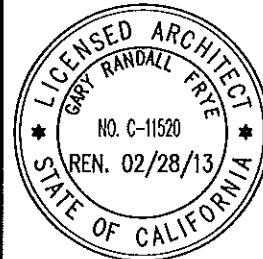

ADDENDUM

DATE:

DSA NO. 01-111835

THIS REVISES IN PART
SHEET: TC-1

SHEET: **SKT-02**

| SYMBOLS | |
|---------|--|
| | WAO. (X) INDICATES NUMBER OF CAT-6A CABLES; NO (X) DEFAULTS TO 3 CABLES. TERMINATE CABLES AT WAO AND IDF/TR/COMPUTER ROOM. PROVIDE 2-GANG DEVICE BOX WITH 1-GANG PLASTER RING AND 1" C TO CABLE TRAY OR IDF/TR |
| | WAO. (X) INDICATED NUMBER OF CAT-6A CABLES; NO (X) DEFAULTS TO 3 CABLES. TERMINATE CABLES IN SMR OR SYSTEM FURNITURE AND IDF/TR/COMPUTER ROOM. |
| | WAO @48" AFF. WALL PHONE FACEPLATE OR SPECIAL USE. TERMINATE SINGLE CAT-6A CABLE AT FACEPLATE AND IDF/TR. PROVIDE 2-GANG DEVICE BOX WITH 1-GANG PLASTER RING AND 1" C TO CABLE TRAY OR IDF/TR |
| | REMOVE (E)WAO AND ASSOCIATED CABLE |
| | 2-GANG DEVICE BOX WITH 1" C TO IDF/TR/CABLE TRAY FOR COMMUNICATIONS USE. PROVIDE CABLE WHIP BETWEEN J-BOX AND SYSTEM FURNITURE. J-BOX AND CONDUIT PER DIVISION 16 |
| | CONDUIT OR SLEEVE. 1" C U.O.N. SEE DIVISION 16 FOR ADDITIONAL REQUIREMENTS. EXTEND CONDUIT TO CABLE TRAY (WHERE CABLE TRAY IS SHOWN) |
| | SURFACE MOUNTED RACEWAY (SMR) PER DIV 16. MOUNTING HARDWARE SPECIFIC TO COMMUNICATIONS PER DIVISION 17. |
| | FLOORBOX. PER DIV 16. REFER TO E-SERIES SHEETS FOR FLOORBOX SCHEDULE. PROVIDE 3 DATA CABLES TO IDF/TR/COMPUTER ROOM |
| | OVERHEAD PROJECTOR AND MOUNT SHOWN FOR REFERENCE (BY OTHER DIVISIONS) |
| | CABLE TRAY. TRAY SIZE IS 1-1/2"X8" U.O.N. |

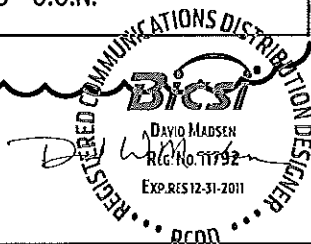

MADSEN & ASSOCIATES
 21 PALO ALTO COURT
 PLEASANT HILL, CA 94523
 P: 925.216.1675 F: 925.271.8805
 EMAIL: DMADSEN@MADSEN.COM

**Business & Central Services Remodel
 LOS MEDANOS COLLEGE**

Pittsburg, CA
 Contra Costa Community College
 School District

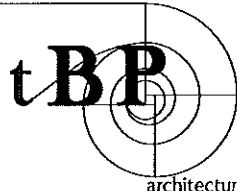

ARCHITECT
 tBP/Architecture
 1000 Burnett Ave, Suite 140
 Concord, CA 94520
 p: 925.246.6419 f: 925.246.6495

architecture
 planning
 interiors
 management

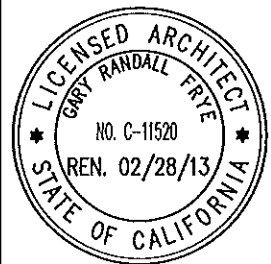

| |
|----------------------------------|
| ADDENDUM |
| DATE: |
| DSA NO. 01-111835 |
| THIS REVISES IN PART SHEET: TC-1 |
| SHEET: SKT-03 |

ADDENDUM No.
 DSA FILE # T-C1
 DSA APPL.# 01-111835

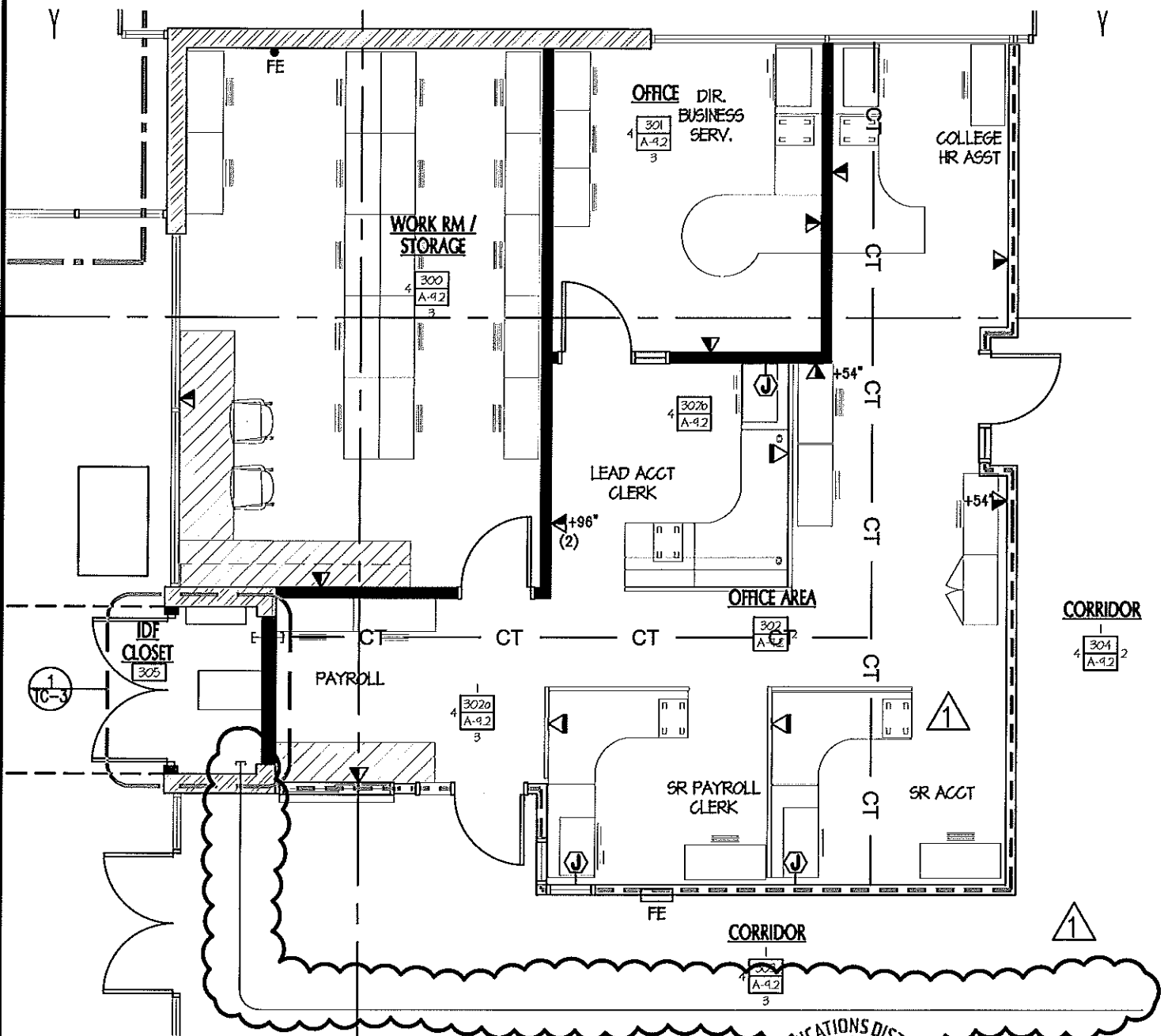

Bicsi
 David Madsen
 REG. NO. 11792
 EXP. RES. 12-31-2011

MADSEN & ASSOCIATES
 21 PALO ALTO COURT
 PLEASANT HILL, CA 94523
 P: 925.216.1575 F: 925.271.8805
 EMARLODAVENMADSEN.COM

Business & Central Services Remodel
LOS MEDANOS COLLEGE
 Pittsburg, CA
 Contra Costa Community College
 School District

ARCHITECT
 tBP/Architecture
 1000 Burnett Ave, Suite 140
 Concord, CA 94520
 p: 925.246.6419 f: 925.246.6495

tBP
 architecture
 planning
 interiors
 management

LICENSED ARCHITECT
 GARY RANDALL FRYE
 NO. C-11520
 REN. 02/28/13
 STATE OF CALIFORNIA

| |
|----------------------------------|
| ADDENDUM |
| DATE: |
| DSA NO. 01-111835 |
| THIS REVISES IN PART SHEET: TC-1 |
| SHEET: SKT-04 |

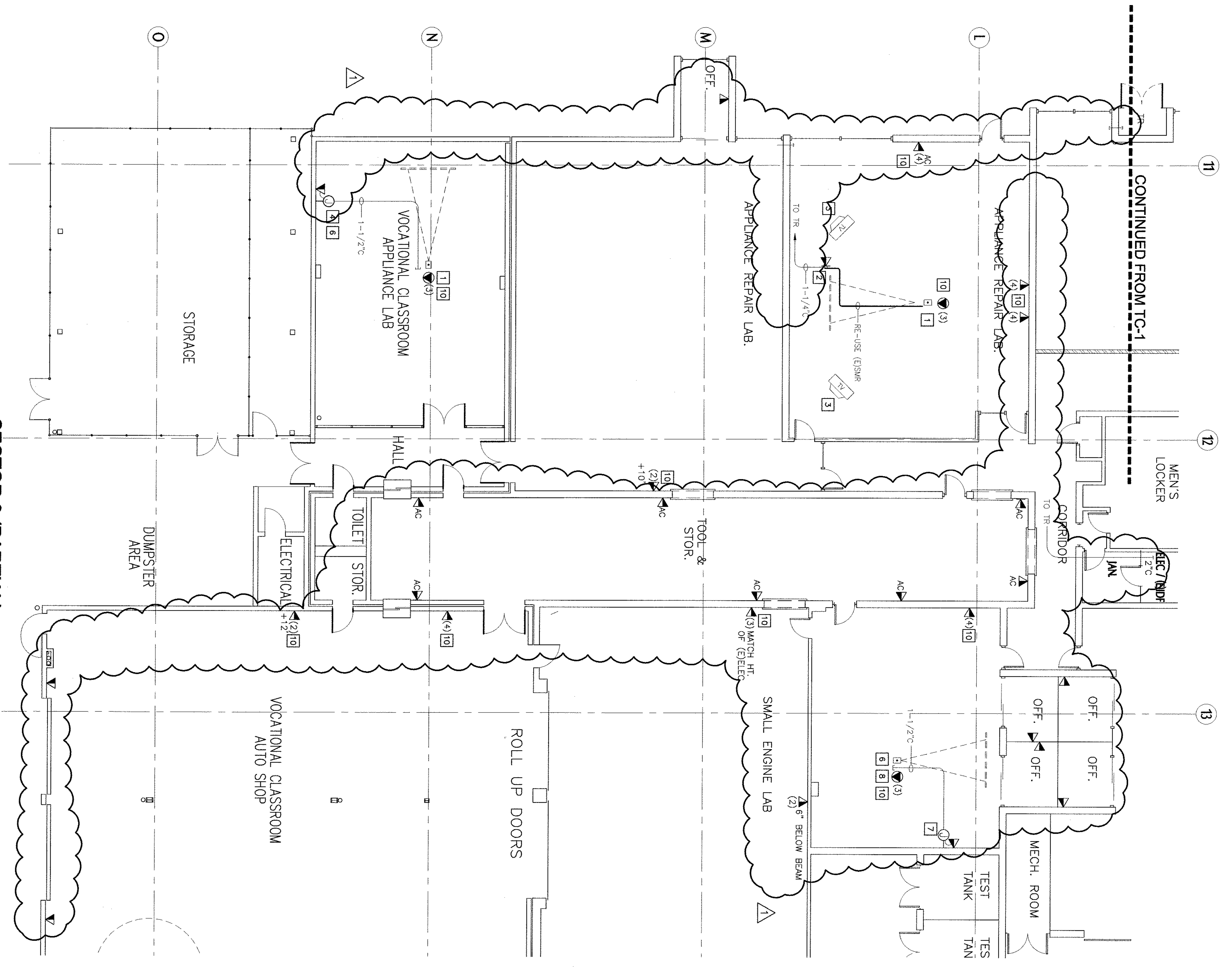

1 SECTOR 9 (PARTIAL)
COMMUNICATIONS AND RACEWAY SCALE: 1"=66"

CONDUIT SIZE MAX. NO. OF CAT-6 CABLES

| | |
|----------|----|
| 1-1/4" C | 8 |
| 1-1/2" C | 11 |
| 2" C | 19 |
| 2-1/2" C | 30 |
| 3" C | 43 |
| 4" C | 76 |

3 CONDUIT CAPACITY
COMMUNICATION CABLES PER CONDUIT

CHANGES REFLECT THE CONDUIT RATHER THAN CABLES. ANY TOP OF FACE DIMS BEING USED FOR COMMUNICATIONS CABLING PATHWAYS.

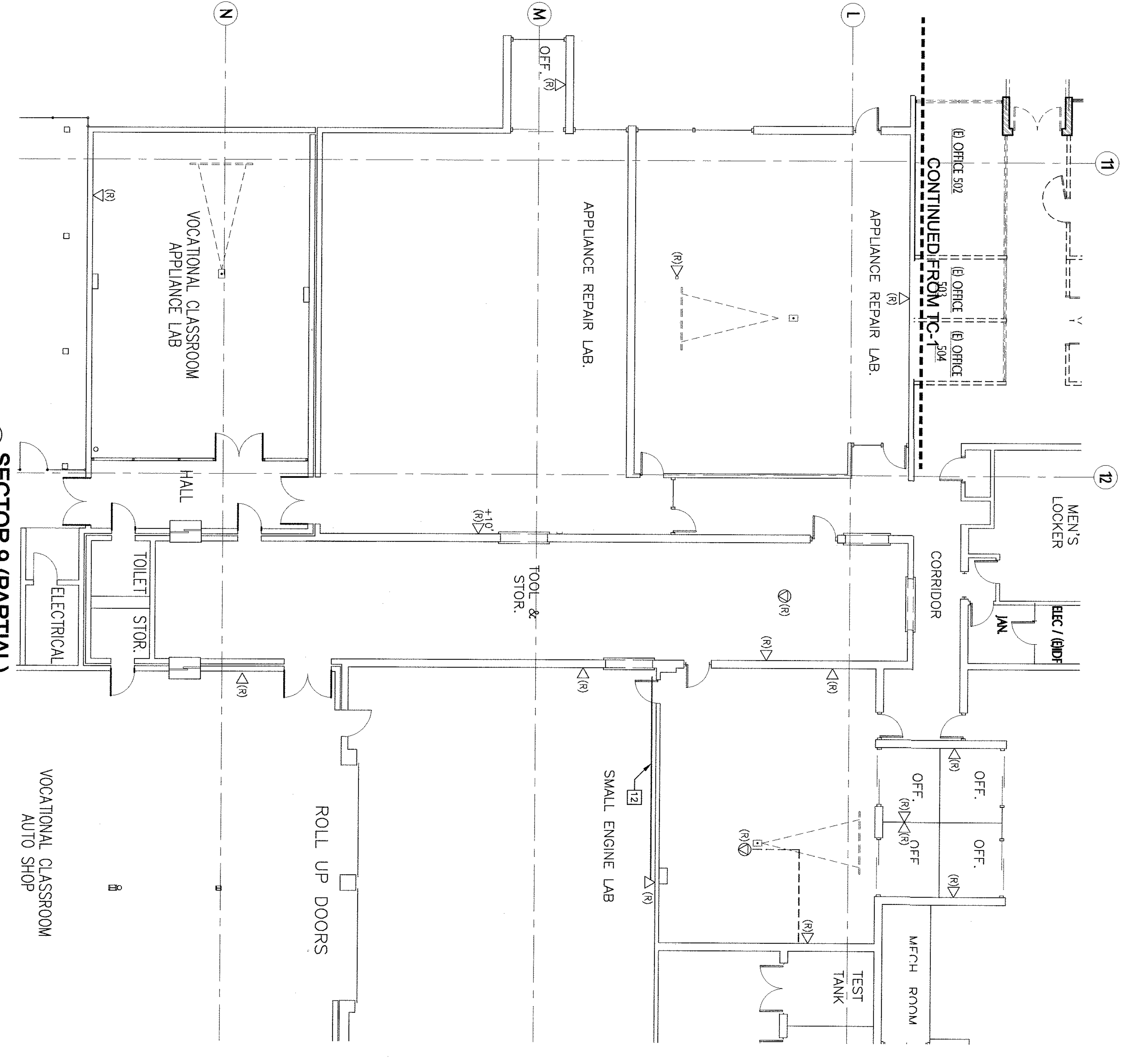

2 SECTOR 9 (PARTIAL)
COMMUNICATIONS DEMOLITION PLAN SCALE: 1"=96"

- GENERAL NOTES:**
- REFER TO SHEET TC-1 FOR ADDITIONAL GENERAL NOTES.
 - REFER TO SECTION 16030 - GENERAL ELECTRICAL - FOR CONDUIT SELECTIONS.
 - PROVIDE CONDUIT BETWEEN WAO AND PULL BOX OR TR. SIZE CONDUITS PER DETAIL 3 (THIS SHEET)
 - SEE TC-1 FOR SYMBOLS
 - PROVIDE 4"x4" DEVICE BOXES AND SINGLE GANG RING AT WAO LOCATIONS
 - PROVIDE PULL BOXES AS REQUIRED - MINIMUM SIZE PER NEC. DO NOT USE PULL BOXES TO CHANGE DIRECTION OF CABLE PULL



- SHEET NOTES:**
- PROVIDE 2-GANG WAO DEVICE BOX WITH 1-GANG RING, FOR TERMINATION OF UTP CABLING
 - TERMINATE UTP CABLING IN (E)POWER POLE. PROVIDE 1-GANG FACEPLATE FOR UTP CABLING. PROVIDE 1-GANG FACEPLATE WITH 1-1/2" CENTER HOLE FOR EGRESS OF AV CABLING. PROVIDE 3-FOOT AV CABLE WHIP
 - COAX CABLING TO TV TO REMAIN
 - PROVIDE 1-1/2" C BETWEEN PROJECTOR LOCATIONS AND J-BOX FOR ROUTING OF AV CABLING.
 - NOT USED
 - ROUTE (E)AV CABLING BETWEEN OVERHEAD PROJECTOR AND J-BOX. PROVIDE 3' SERVICE LOOP AT PROJECTOR
 - PROVIDE 3/4" C BETWEEN J-BOX AND WAO DEVICE BOX
 - ROUTE (E)AV CABLING AND CAT-6 THROUGH 1-1/2" C. ROUTE CAT-6 THROUGH J-BOX AND WAO DEVICE BOX AND TERMINATE IN TR.
 - NOTE USED
 - PROVIDE ONLY BLUE MODULAR CONNECTORS/JACKS
 - NOT USED
 - RE-USE OF (E)SMR IS PERMITTED



BUSINESS & CENTRAL SERVICES REMODEL COLLEGE COMPLEX
BID DOCUMENTS

LOS MEDANOS COLLEGE
2700 EAST LELAND DRIVE
PITTSBURG, CA 94565

IDENTIFICATION STAMP
DIV. OF THE STATE ARCHITECTURE
OFFICE OF REGULATION SERVICES

FILE NO. 7431
APPL# 01-77835
AC: RLS SS
DATE: 02/28/13

Division of the State Architect
Regional Office
1515 Clay St. Suite 1201
Oakland, Ca. 94612
ph: 510-622-3101

Madsen & Associates
21 PALO ALTO COURT
PLEASANT HILL, CA 94523
P: 925.216.1575 F: 925.271.8805
EMAIL@DAVEMADSEN.COM

tBP Architecture
1000 Burnett Avenue Suite 320
Concord, CA 94520
ph: 925.246.6419 fx: 925.246.6495

tBP
architecture
planning
interiors
management

| | | |
|------------|-------|-------------------------|
| owner | owner | |
| file name | TC2R | |
| drawn by | DM | |
| checked by | | |
| date | | |
| rev. | date | description |
| 01/28/11 | | PSA SUBMITTAL DOCUMENTS |
| 04/01/11 | | PSA BACK CHECK |

THIS DRAWING AND THE DESIGN, STRUCTURE, SPECIFICATIONS AND CONSTRUCTION THEREOF ARE THE PROPERTY OF MADSEN & ASSOCIATES. NO PART OF THIS DRAWING OR THE INFORMATION CONTAINED HEREIN IS TO BE REPRODUCED, COPIED, EITHER WHOLLY OR IN PART, OR TRANSMITTED IN ANY FORM OR BY ANY MEANS, ELECTRONIC OR MECHANICAL, INCLUDING PHOTOCOPYING, RECORDING, OR BY ANY INFORMATION STORAGE AND RETRIEVAL SYSTEM, WITHOUT THE WRITTEN PERMISSION OF MADSEN & ASSOCIATES.

drawing title: **SECTOR 9 COMMUNICATIONS**
drawing no.: **TC-2R**
drawing of: